



NIKLES

MATTE BLACK

2020

content

SHOWER HEADS AND ARMS
06-09



HAND SHOWERS
10-13



SLIDE BARS
14-15



SHOWER SYSTEMS
16-17



FAUCETS
18-27



ACCESSORIES
28-31



company

Nikles Group is one of the world's leading shower equipment manufacturer and supplier. Nikles is a Swiss family owned corporation. We manufacture quality products that are sustainable and durable. Our clients all around the globe, such as luxury manufacturers and leading retailers are sourcing hand showers, shower heads, slide bars, shower systems, and kitchen sprays from us.

Nikles consistently re-invest profits back into research and development resulting in a continuous stream of new products and technologies. We are committed to maintain and to expand our position as a technology partner. Nikles prides itself with products that are trendsetting and state of the art design.

All Nikles products are in compliance with diverse standards in different regions of the world. Our customer base is global with clients from all around the world such as Europe, North America, Asia, Australia, New Zealand, and South America.

As a designer, creator and manufacturer of shower products it is our core purpose to offer to the consumer the right product with an attractive design, appropriate functionality and superior quality and to contribute to the success of our clients and business partners. Our success is built around a team of people with an extraordinary dedication to their professional standards. We believe in the mutual leverage of our business.

Our focus is the creation of products and implementation of strategies to exceed market expectations.



Nikles portrait

Nikles - A Swiss company group



NIKLES INTER AG

Arlesheimerstrasse 5 - CH-4147 Aesch / Basel - Switzerland
Phone +41 61 726 88 66 - Fax +41 61 726 88 69



NIKLES TEC ITALIA SRL

 Via Alessandro Volta, 2 - Z.I. Cornali I-25013 Carpenedolo (BS) - Italy
Phone +39 030 96 98 716 - Fax +39 030 99 66 505



NIKLES XIAMEN SHOWER COMPONENTS CO. LTD.

 Building 15, No. 2881 Dongfu Road - Haitou Dongfu Industrial Park
Haicang Zone - 361027 Xiamen City - China
Phone +86 592 6195961



NIKLES SHOWERS (THAILAND) CO. LTD.

 382 Nice Building 1, 2A Floor, Rachadapisek Rd.
Huai Khwang, Bangkok 10310 - Thailand
Phone +662 693 1031-33 - Fax +662 693 103



NIKLES (USA) INC.

 1725 Corporate Drive, Suite 335 - Norcross, GA 30093 - USA
Phone +1 (678) 668-8103

info@nikles.com - www.nikles.com

Follow us on     







shower heads



Shower head Avanti Dropless 250 Round matte black

DE0507N



Dropless technology

Contemporary, organic design
Rounded edges
Ø 250 mm / H 66 mm
Nikles Dropless Technology
Nikles Easy-To-Clean Technology
Energy saving
12 l/min flow limiter at 3 bar
Adjustable

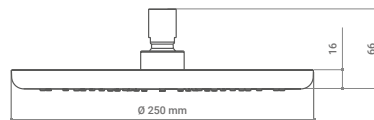

Shower head Avanti Dropless 250 Square matte black

DE0607N



Dropless technology

Contemporary, organic design
Rounded edges
250 x 250 mm / H 66 mm
Nikles Dropless Technology
Nikles Easy-To-Clean Technology
Energy saving
12 l/min flow limiter at 3 bar
Adjustable

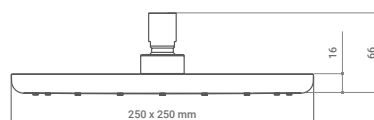

shower heads



Shower head LIPS matte black

BLS.001.07N



NIKLES LIPS

Outstanding contemporary design
Dimensions: 215 x 82.5 mm
Cascade spray with intelligent water distribution
Standard connection G1/2 for easy installation
16 l/min flow limiter at 3 bar

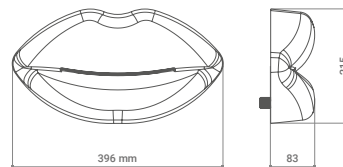

Shower head Avanti 115 Duo Massage matte black

BH0107QDN



Minimalistic, timeless, clean design
Matte black spray plate
Ø 115 mm
2 adjustable sprays: rain and Booster massage functions
Push button system
Nikles "Easy-to-Clean" technology
Energy saving
12 l/min flow limiter at 3 bar
Adjustable

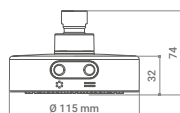

Shower head Avanti 115 Duo Silk matte black

BH0207QDN



Minimalistic, timeless, clean design
Matte black spray plate
Ø 115 mm
2 adjustable sprays: rain and Silk spray functions
Push button system
Nikles "Easy-to-Clean" technology
Energy saving
12 l/min flow limiter at 3 bar
Adjustable

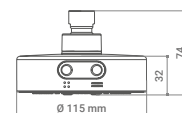

Silk spray

shower arms



Shower arm
XL 24 300 mm matte black

A48.L30.000.07N

Ø 24 mm

Escutcheon Ø 60 mm

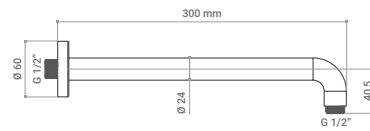

Shower arm
XL 24 120 mm matte black

A48.B12.000.07N

Ø 24 mm

Escutcheon Ø 60 mm

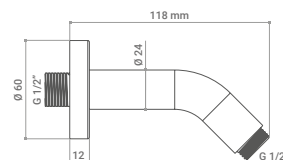



hand showers



Hand shower
Avanti 110 Uno matte black

BS2107N



Contemporary, organic design
Rounded edges
Ø 110 mm
Rain spray
Nikles "Easy-to-Clean" technology
Energy saving
12 l/min flow limiter at 3 bar



Hand shower
Avanti 110 Duo matte black

BS2107QDN



Contemporary, organic design
Rounded edges
Ø 110 mm
2 adjustable sprays: rain and
massage functions
Push button system
Nikles "Easy-to-Clean" technology
Energy saving
12 l/min flow limiter at 3 bar



hand showers



Hand shower Stick matte black

B1507N



Straight, clean, smooth, cylindrical design

Ø 25 mm x 187 mm

Wide angle spray plate

Nikles "Easy-to-Clean" technology

Energy saving

Thermo-insulated handle

12 l/min flow limiter at 3 bar



slide bars



Slide bar
Techno Ø 24 - 90 cm matte black

86007T/90N

Minimalistic, timeless, clean design
 Ø 24 mm 90 cm
 Slider with knob lock and swivel support
 High resistance slide bar
 Easy installation



Slide bar
Techno Ø 24 - 90 cm Free fixation matte black

87007T/90N

Minimalistic, timeless, clean design
 Ø 24 mm 90 cm
 Slider with knob lock and swivel support
 High resistance slide bar
 Easy installation
 Free Fixation



System
5 SKY matte black

B75.00.000.07N

- Contemporary, organic design
- Rounded edges
- 2-way non-sharing diverter
- Easy renovation



Installation Instruction

kit system



Kit thermostatic Architect 24 matte black

A65TH.62.53D.07N



Shower head Fresh 250 Round / Hand shower Avanti 110 Duo
Thermostatic mixer Architect, DN 15 (G1/2") for wall installation
Feel Cool - Nikles safety housing in ABS with scalding protection
Thermostatic cartridge with scalding protection and safety stop at 38°C
Easy Selector 2-Way Diverter cartridge with shut-off function
Shower hose S05 with swivel connection



faucets

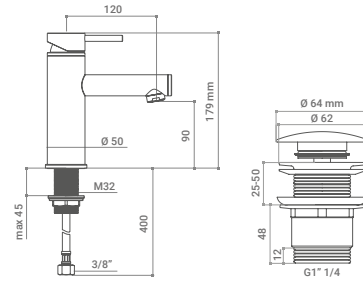

Basin Faucet matte black

FBA.01.001.07N

Normal spray
Spout projection 90 mm
Spout height 120 mm
With drainage in matte black
Connection hose length 355 mm
12 l/min flow rate at 3 bar

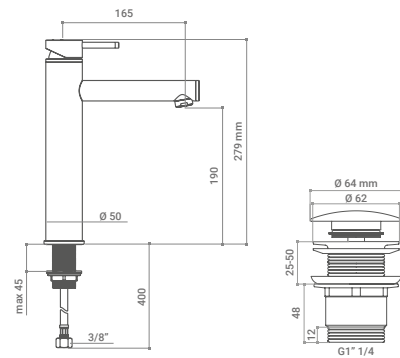

Basin Faucet Tall matte black

FBT.01.001.07N

Normal spray
Spout projection 166 mm
Spout height 190 mm
With drainage in matte black
Connection hose length 405 mm
12 l/min flow rate at 3 bar



faucets

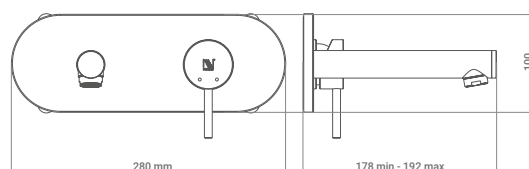

Esthetical assembling kit for Concealed Basin Faucet matte black

FBC.01.501.07N

Single lever faucet
Spout projection 213 mm
280 x 100 mm
7,5 l/min flow rate at 3 bar

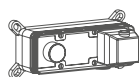

Installation Kit

FBC.01.500.07N

Page 28



faucets

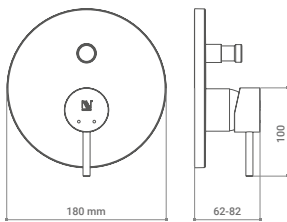

**Esthetical assembling kit for
Concealed Shower 2 Ways matte black**

FCD.01.501.07N

Ø 180 mm
2 Ways diverter
Single lever mixer



Installation Kit
FCD.01.500.07N
Page 28

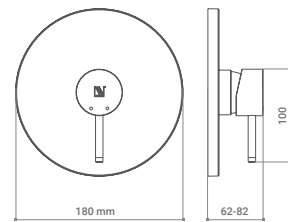

**Esthetical assembling kit for
Concealed Shower 1 Way matte black**

FCU.01.501.07N

Ø 180 mm
1 Way
Single lever mixer



Installation Kit
FCU.01.500.07N
Page 29



faucets

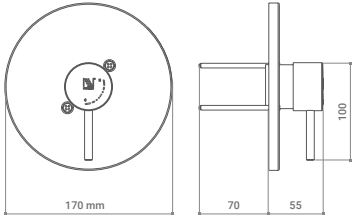

**Esthetical assembling kit for
Concealed Pressure Balance Valve matte black**

FCP.01.501.07N

Ø 180 mm

Single lever temperature control



Installation Kit

FCU.01.500.00N

Page 29



faucets

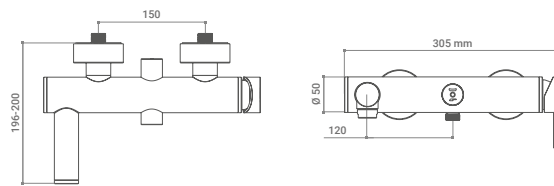

Faucet Bath matte black

FBH.01.001.07N

Single lever faucet

Ø 50 mm X 305 mm

Spout length 100 mm

20 l/min flow rate at 3 bar (spout)

13,5 l/min flow rate at 3 bar (hand shower)

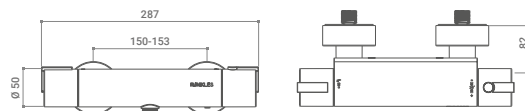

Thermostatic 1 Way Techno matte black

A65RU.TH1.001.07N

Shower thermostatic mixer, DN 15 (G ½) for wall mounting with anti-scald device

Brass thermostat body

Feel cool: Nikles safety housing in ABS with scalding protection

High quality thermostatic cartridge with temperature control, anti-scald at 38° celsius

Easy selector: 35 mm, High quality, ceramic, 1-way, S-connections

accessories

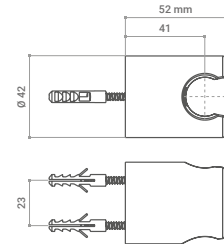

Wall bracket techno fix matte black

8607N

Ø 42 mm
Lenght 52 mm

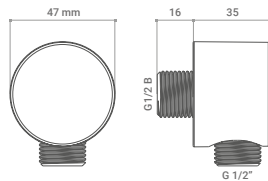

Wall elbow techno matte black

298607N

Ø 46 mm
Lenght 35 mm

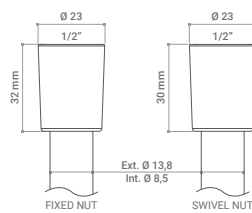

Shower hose S05 matte black

S05.361.363.150.27N

Lenght 150 cm
Fix and swivel conical nuts

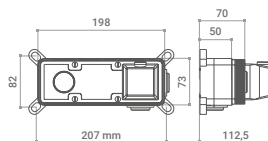
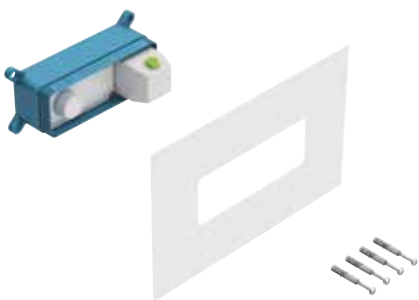

**Installation Kit for
Concealed Basin Faucet**

FBC.01.500.07N

Lenght 112,5 mm

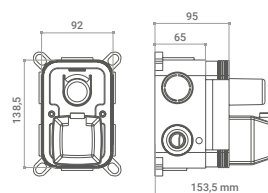

**Installation Kit for Concealed Shower
2 Ways**

FCD.01.500.07N

2 Ways button diverter
Lenght 112,5 mm

accessories

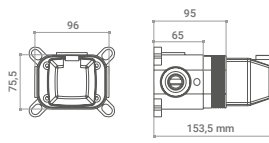

**Installation Kit for Concealed Shower
1 Way**

FCU.01.500.07N

Lenght 112,5 mm

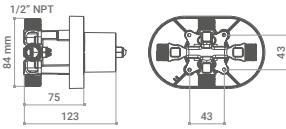

**Installation Kit for
Concealed Pressure Balance Valve**

FCP.01.500.00N

Lenght 123 mm

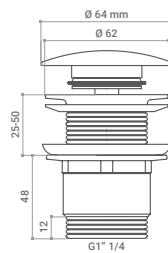

Click-Clack without overflow matte black

FAP.02.001.07N

Ø 63 mm - G 1" 1/4"

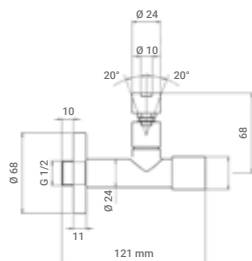

Corner valve with escutcheon matte black

FAT.21.001.07N

G 1/2" x Ø 10

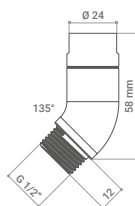

45° Bracket matte black

H000107N

G 1/2" - Ø 24 mm

accessories

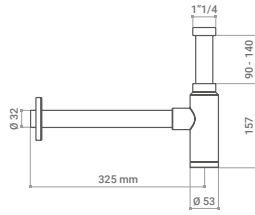

Siphon matte black

FAS.01.000.07N

G 1" 1/4" - Ø 32 mm



Towel bar 45 cm matte black

FTB.001.07N

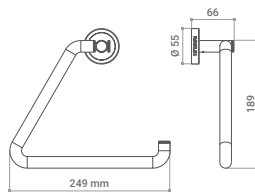

Towel holder matte black

FTH.001.07N

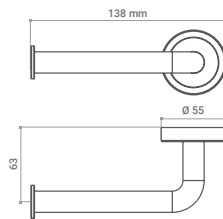

Toilet paper holder matte black

FPH.001.07N

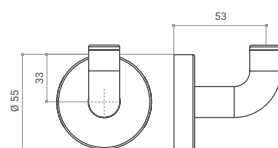

Hook matte black

FHK.001.07N

accessories

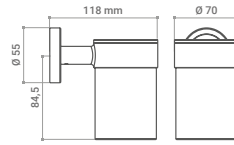

Tooth brush holder matte black

FHB.001.07N

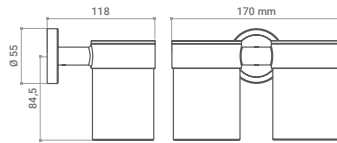

Tooth brush holder duo matte black

FHB.002.07N

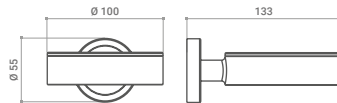

Soap dish holder matte black

FSH.001.07N

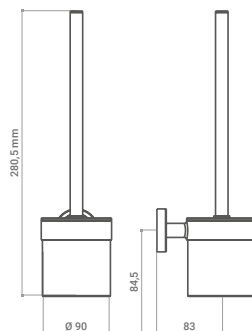

Toilet brush matte black

FTT.001.07N

Important Information about Nikles product surface finishes

Nikles takes pride in producing high quality products and providing superior surface finishes.

Natural minor differences in surface treatments occur due to

- material composition (e.g. plastic, brass, stainless steel),
- environmental conditions
- and other external influences that can not be controlled during the production process.

Surface abrasions that occur due to improper cleaning supplies, use and handling of products are excluded from the warranty. Do not use detergents that contain ammonia, bleach or acid. Rinse the product thoroughly and wipe it dry with a soft cloth after each use.

We recommend that you read and follow our maintenance instructions carefully.

